

TOP VIEW

FRONT VIEW

BOTTOM VIEW

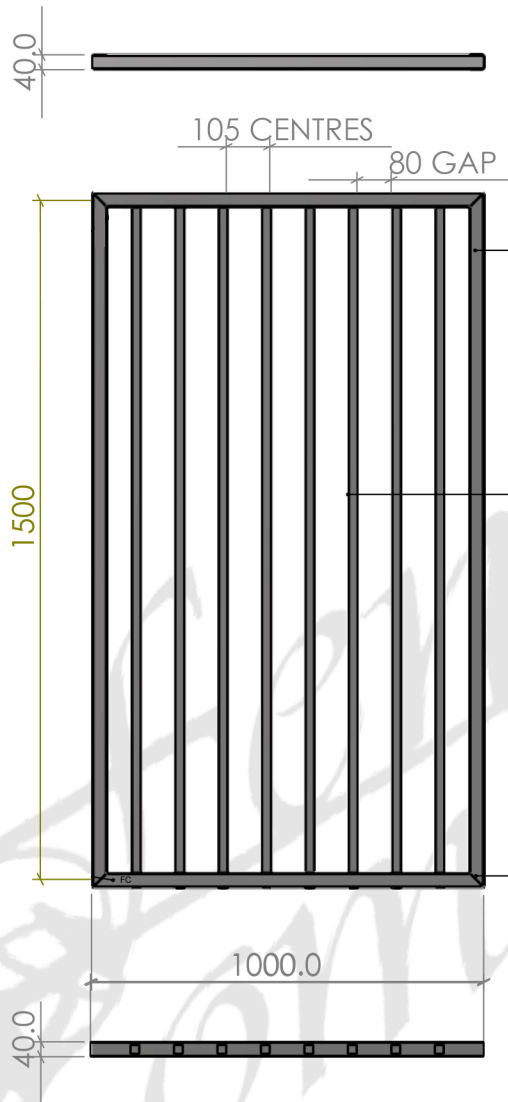

40x40x1.6  
SHS FULL FRAME

25x25x1.2  
SHS VERTICAL

MITRED CORNERS  
ON ALL SIDES

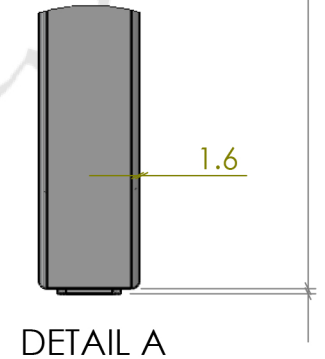

40.0

TOP RAIL WELD POINTS

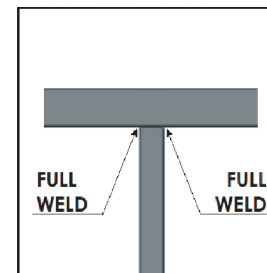

BOTTOM RAIL WELD POINTS

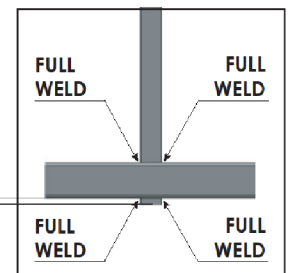

SIX (6) POINT  
SILICON BRONZE  
WELDS PER PICKET

PROTRUSION  
NO MORE  
THAN 2MM

GENERAL NOTES :

1. STEEL TUBE TO COMPLY WITH AS1450 DESIGNATION C250 MINIMUM
2. GAL COATING TO BE NO LESS THAN 100G/SQM BOTH SIDES
3. STEEL TUBE TO BE PRE-TREATED; INCLUDES SANDBLASTING AND NANO COATING
4. ALL WELDS TO BE SILICON BRONZE
5. POWDER COATING TO COMPLY WITH AS4506 - HUAJIA 10 YEAR WARRANTY



FENCING COMPONENTS PTY LTD  
58 GOVERNOR MACQUARIE DR  
CHIPPING NORTON NSW 2170  
02 9755 2666  
WWW.FENCINGCOMPONENTS.COM.AU  
SALES@FENCINGCOMPONENTS.COM.AU

COLOUR:

[BLK] SATIN BLACK

MATERIAL:

STEEL

PRODUCT NAME :

FLAT TOP SECURITY PEDESTRIAN GATEL  
1500 x 1000W

PRODUCT CODE :

FPSBLK-GP-G-1015-80

ALL OF THE INFORMATION SHOWN HEREIN IS THE PROPERTY OF FENCING COMPONENTS PTY LTD. IT IS SUBMITTED ONLY ON A CONFIDENTIAL BASIS. THE RECIPIENT AGREES THAT NO DISCLOSURE OF THIS INFORMATION WILL BE MADE TO A THIRD PARTY WITHOUT WRITTEN CONSENT FROM FENCING COMPONENTS PTY LTD

DRAWING NOT TO SCALE - ALL DIMENSIONS ARE IN MILLIMETRES UNLESS NOTED OTHERWISE